

## THE EFFECTS OF TREE-VIEW BASED PRESENTATION ADAPTATION ON MOBILE WEB BROWSING

**Boonlit Adipat**

Graduate School of Management and Innovation, King Mongkut's University of Technology Thonburi,  
126 Pracha-Utit Road, Bangmod, Thung-Khru, Bangkok, THAILAND 10140 {boonlitadipat@gmail.com}

**Dongsong Zhang, Lina Zhou**

Department of Information Systems, University of Maryland, Baltimore County, 1000 Hilltop Circle,  
Baltimore, MD 21250 U.S.A. {zhangd@umbc.edu}, {zhou@umbc.edu}

### Appendix A

#### Interfaces of Mobile Web Prototype Systems

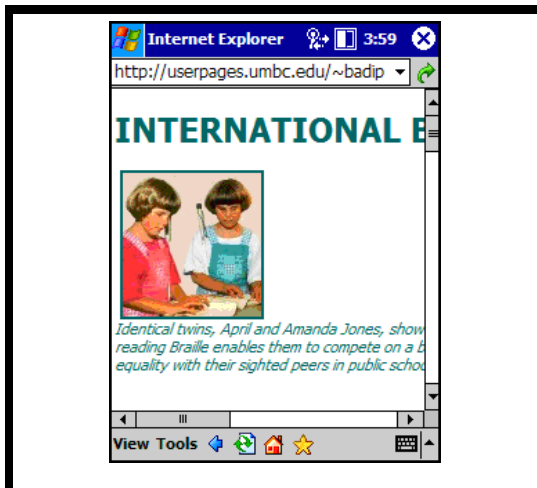

**Figure A1. The Original (O) Version of the System (Direct Presentation Without Any Adaptation)**

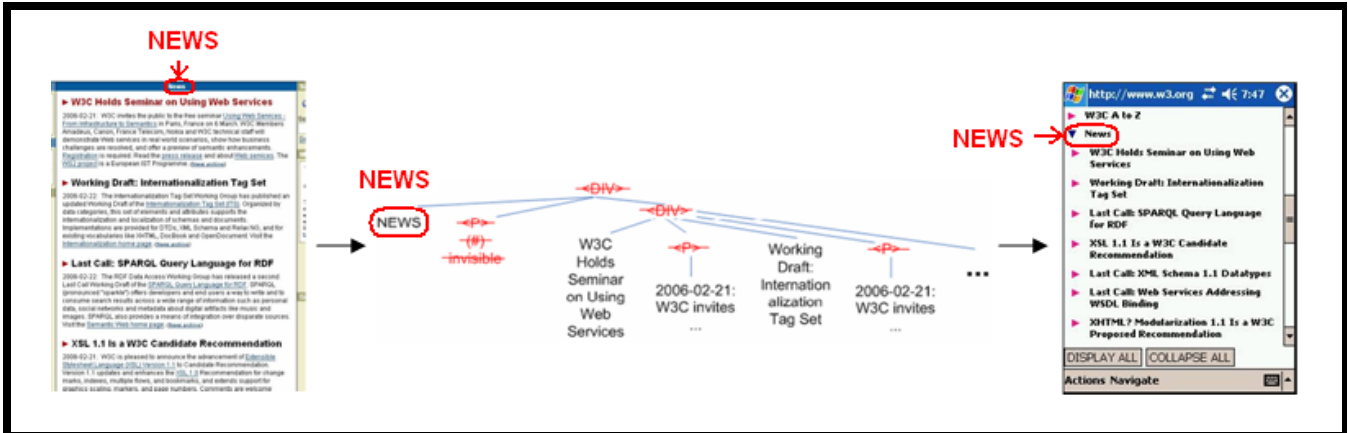

Figure A2. Generating a DOM Tree-View Presentation

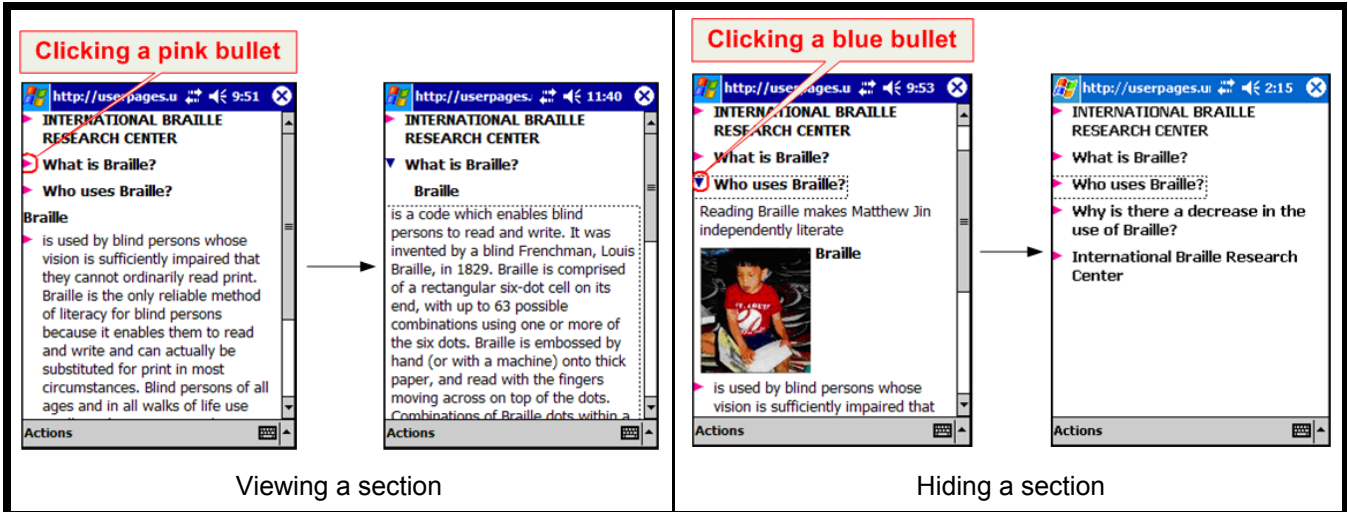

Figure A3 Tree-View Presentation Adaptation

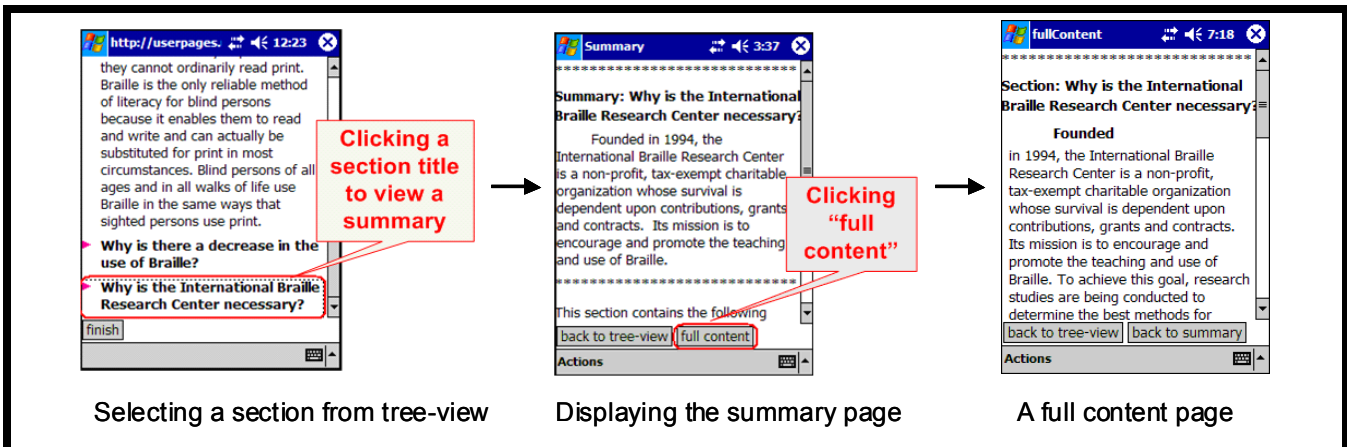

Figure A4 Presentation Adaptation by Hierarchical Text Summarization in Tree View

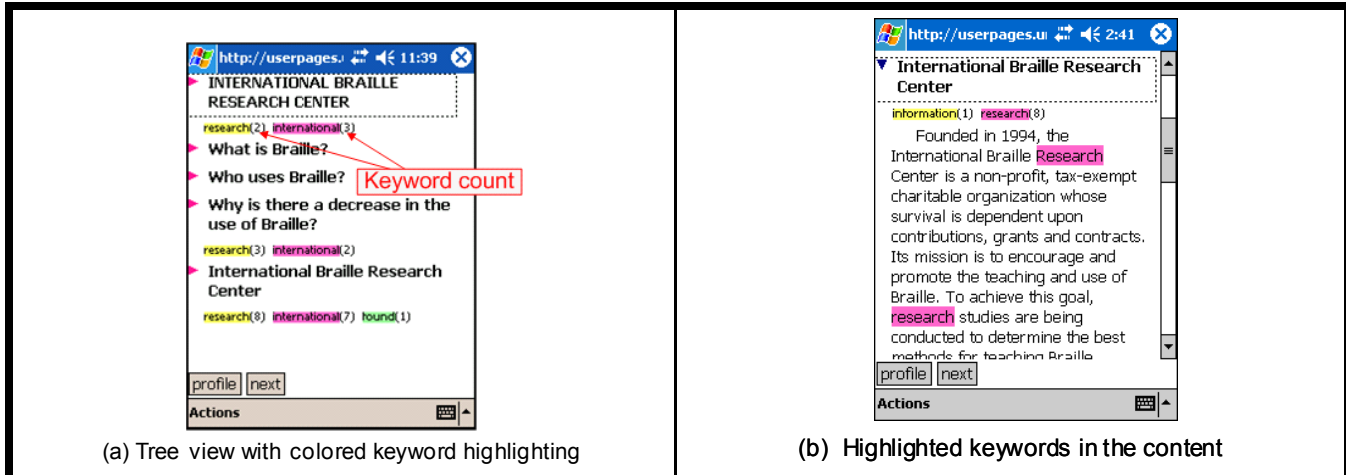

Figure A5 Presentation Adaptation by Colored Keyword Highlighting in Tree View

## Appendix B

### Questionnaire

Please circle only ONE answer for each question that best indicates your perception of the mobile Web system.

1. I found the system was easy to learn.
 

Strongly disagree	Disagree	Somewhat disagree	Neutral	Somewhat agree	Agree	Strongly agree
1	2	3	4	5	6	7
2. I found the system was easy to use.
 

Strongly disagree	Disagree	Somewhat disagree	Neutral	Somewhat agree	Agree	Strongly agree
1	2	3	4	5	6	7
3. I found the Web page was displayed in a way that was clear and understandable.
 

Strongly disagree	Disagree	Somewhat disagree	Neutral	Somewhat agree	Agree	Strongly agree
1	2	3	4	5	6	7
4. I found the system was useful for completing the tasks.
 

Strongly disagree	Disagree	Somewhat disagree	Neutral	Somewhat agree	Agree	Strongly agree
1	2	3	4	5	6	7
5. I could find information I wanted quickly.
 

Strongly disagree	Disagree	Somewhat disagree	Neutral	Somewhat agree	Agree	Strongly agree
1	2	3	4	5	6	7
6. I found the Web page was displayed in a way that was useful in searching for information.
 

Strongly disagree	Disagree	Somewhat disagree	Neutral	Somewhat agree	Agree	Strongly agree
1	2	3	4	5	6	7

7. Overall, if you need to access Web from mobile handheld devices, please rank the following systems you prefer to use (with the most favorable system as 1 and the least favorable system as 5).
- \_\_\_\_\_ Mobile Web system that displays a Web page directly as it is
  - \_\_\_\_\_ Mobile Web\_Tree view system
  - \_\_\_\_\_ Mobile Web\_Tree view and hierarchical text summary system
  - \_\_\_\_\_ Mobile Web\_Tree view and colored keyword highlighting system
  - \_\_\_\_\_ Mobile Web\_ALL system that integrates tree-view, hierarchical text summarization, and colored keyword highlighting

## Appendix C

### Supplementary Materials

#### Sample Questions Used in the Study

- (1) Who was often credited for developing the LA (Los Angeles) style of Salsa dance?  
Answer: Francisco Vasquez
- (2) Who was the self-proclaimed “King of Jazz” between 1910 and 1930?  
Answer: Paul Whiteman
- (3) In the ancient Olympics, who was the only athlete in history to win a victory in six Olympics?  
Answer: Milo of Croton
- (4) In the Eonile, how deep can the sand-filled canyon reach?  
Answer: 1400 meters
- (5) What is the top speed of a new generation of high-speed rail train FASTECH in Japan?  
Answer: 405 km/hour

#### Search Accuracy of Simple and Complex Tasks Using the Five Mobile Web Systems

